



ELEGANT AND RELIABLE PFC UPS



Line-interactive
UPS Topology



Energy Saving
Technology



Pure Sine Wave
Output



Automatic Voltage
Regulation (AVR)



LCD Status
Display



PowerPanel
Management
Software

The Pure Sine Wave UPS for equipment requiring active PFC power source

Designed for home, office and back office applications, the PFC Sinewave Series adopts line-interactive topology with Automatic Voltage Regulation (AVR) function to offer stabilized Pure Sine Wave output. The products are compatible with equipment requiring active PFC power supply. Other features include RJ11/RJ45 port to provide data line protection against surge and spike, and power management software to perform PC graceful shutdown.

SERIES FEATURES

- Line-interactive UPS Topology
- Energy Saving Technology
- Active PFC Compatible
- Pure Sine Wave Output
- Automatic Voltage Regulation (AVR)
- LCD Status Display
- PowerPanel Management Software
- Surge and Spike Protection
- Phone/Fax/Modem/DSL/Network Protection
- USB Charging Port(s)

PRODUCT CALLOUTS

1. Power On Indicator
2. Power On/Off Switch
3. LCD Display Panel
4. Function Button(s)
5. Battery Backup & Surge Protected Outlets
6. Communication Protection Ports RJ11/RJ45
7. USB Charging Ports
8. Input Circuit Breaker
9. AC Inlet
10. USB Port
11. Serial Port

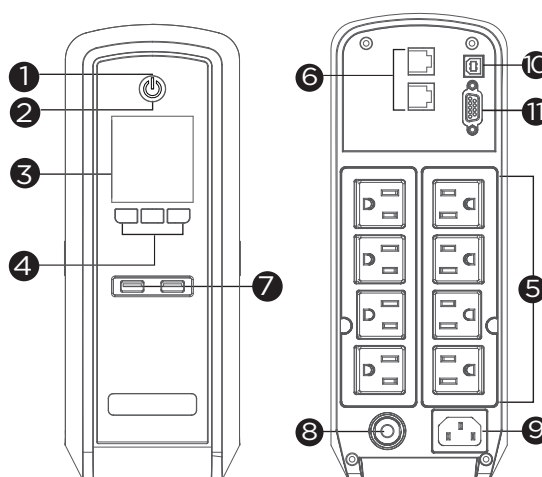

CP1500EPFCLCD



TECHNICAL SPECIFICATIONS

Model Name	CP1500EPFCLCD
General	
UPS Topology	Line-interactive
Energy Saving Technology	GreenPower UPS™ Bypass Technology
Active PFC Compatibility	Yes
Input	
Nominal Input Voltage (Vac)	220, 230, 240
Input Voltage Range (Vac)	170 - 270
Input Frequency (Hz)	50 ± 3, 60 ± 3
Input Frequency Detection	Auto-sensing
Rated Input Current (A)	10
Input Connector Type	IEC C14
Output	
Capacity (VA)	1500
Capacity (Watts)	900
On Battery Waveform	Pure Sine Wave
On Battery Voltage(s) (Vac)	230 ± 10%
On Battery Frequency (Hz)	50 ± 1%, 60 ± 1%
Automatic Voltage Regulation (AVR)	Single Boost
Overload Protection	Internal Current Limiting, Circuit Breaker
Outlet(s) - Total	8
Outlet Type	NEMA 5-15R x 8
Outlet(s) - Battery & Surge Protected	8
USB Charging Port(s)	USB-A x 2
USB Charging Current	5 V/ 2.1 A
Typical Transfer Time (ms)	4
Battery	
Runtime at Half Load (min)	10
Runtime at Full Load (min)	3
Typical Recharge Time (Hours)	8
User Replaceable	Yes
Battery Type	Sealed Lead-acid
Replacement Battery Pack (RBP)	RBP0016
Replacement Battery Pack (RBP) Quantity (pcs)	1
Surge Protection & Filtering	
Surge Suppression (Joules)	405
EMI/RFI Filtration	Yes
Phone/Network Protection RJ11/RJ45 (Combo)	1-in, 1-out
Management & Communications	
LCD Panel	Yes
LED Indicators	Power On
HID Compliant USB Port(s)	1
Serial Port	Dry Contact
Audible Alarms	Battery Mode, Low Battery, Overload, UPS Fault
Power Management Software	PowerPanel Personal (Recommended)
Physical	
Form Factor	Tower
Physical Size - UPS Module	
Dimensions (WxHxD) (mm.)	100 x 265 x 370
Weight (kg.)	11.3
Environmental	
Operating Temperature (°C)	0 - 40
Operating Relative Humidity (Non-condensing) (%)	0 - 95
Online Thermal Dissipation (BTU/hr)	61
Certifications	
RoHS	Yes

*Certifications may vary according to different regions. Visit www.cyberpower.com for more information.
#All specifications are subject to change without notice.